

**ehB**  
RESIDENTIAL

Your Property - Our Business



42, Chandley Wharf, Warwick

£1,300 Per Month



Welcome to this exquisite executive apartment located in the charming Chandley Wharf, Warwick. This stunning property boasts not only a prime location but also a range of desirable features that are not to be missed.

Benefitting from secure communal entrance to stairs up to the first floor to the apartment's private entrance hall which leads to a bright and spacious living/dining room that offers a perfect setting for entertaining guests or

simply relaxing after a long day. The views over the Grand Union Canal add a touch of tranquillity to the living space, creating a serene atmosphere.

The property comprises two well-appointed bedrooms, including a master bedroom with fitted wardrobe and an en-suite bathroom for added convenience. The second bedroom provides ample space for guests or can be utilised as a home office, catering to your

individual needs.

The modern fitted kitchen includes a washing machine, dishwasher, fridge/freezer, oven, and induction hob.

Parking will never be an issue with the garage parking included with this property, providing secure storage for your vehicle and additional belongings.





In conclusion, this apartment offers a luxurious lifestyle in a sought-after location.

Don't miss the opportunity to make this stunning property your new home.



# FIRST FLOOR 748 sq.ft. (69.5 sq.m.) approx.

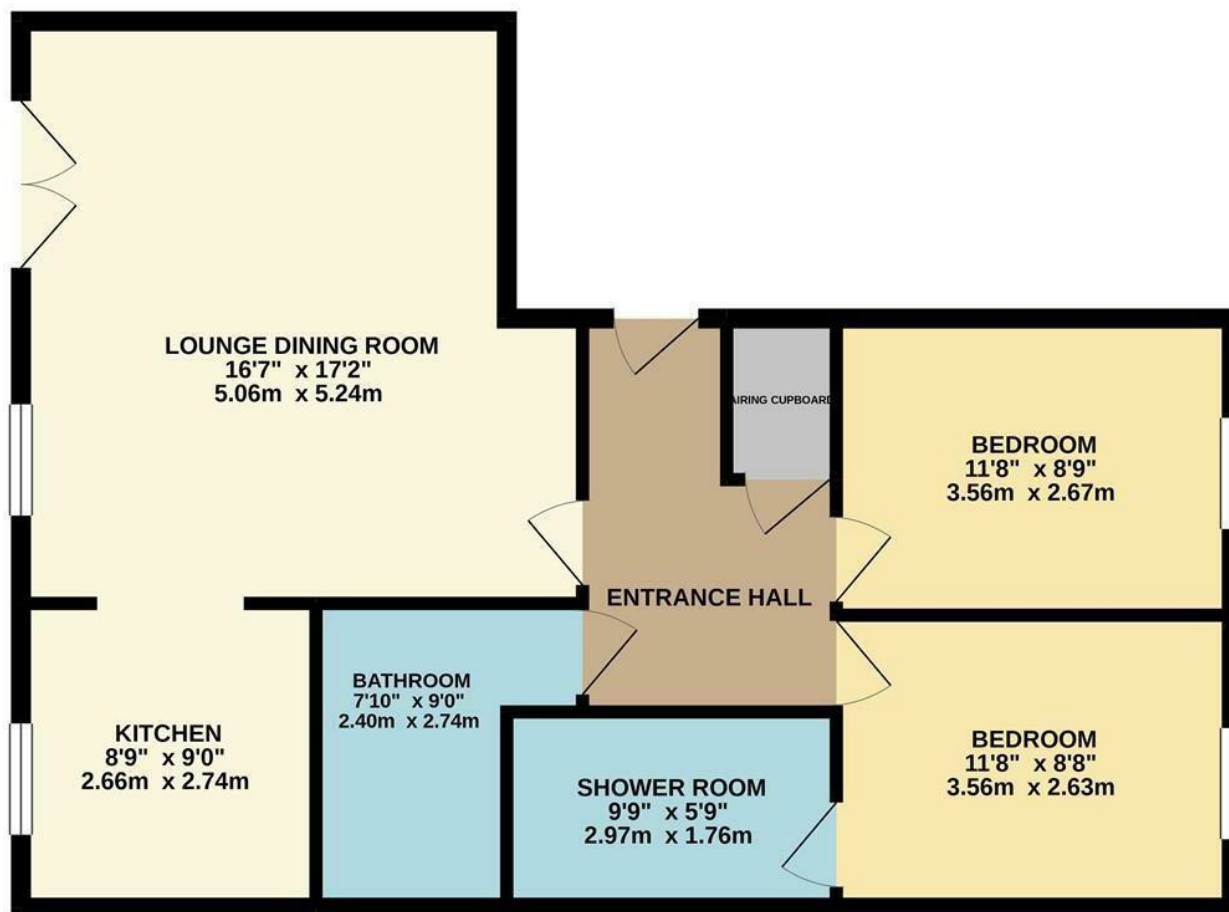

TOTAL FLOOR AREA: 748 sq.ft. (69.5 sq.m.) approx.

Whilst every attempt has been made to ensure the accuracy of the floorplan contained here, measurements of doors, windows, rooms and any other items are approximate and no responsibility is taken for any error, omission or mis-statement. This plan is for illustrative purposes only and should be used as such by any prospective purchaser. The services, systems and appliances shown have not been tested and no guarantee as to their operability or efficiency can be given.  
Made with Metropix ©2020

Your Property - Our Business

- Residential Estate Agents •
- Lettings and Property Managers •
- Land and New Homes Agents •

Warwick Office  
17-19 Jury Street  
Warwick  
CV34 4EL

01926 499540 ehbresidential.com

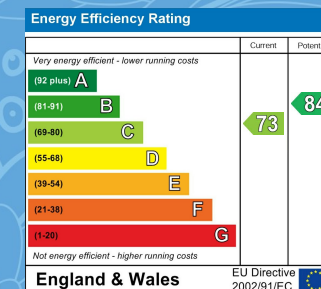

Also at: Leamington Spa, Somerset House,  
Clarendon Place, Royal Leamington Spa CV32 5QN

**IMPORTANT NOTICE** ehB Residential for themselves and for the Vendors of this property, whose agents they are, give notice that:- 1. The particulars are intended to give a fair and substantially correct overall description for the guidance of intending purchasers and do not constitute part of an offer or contract. Prospective purchasers and lessees ought to seek their own professional advice. 2. All descriptions, dimensions, areas, reference to condition and necessary permissions for use and occupation and other details are given in good faith, and are believed to be correct, but any intending purchasers should not rely on them as statements or representations of fact, but must satisfy themselves by inspection or otherwise as to the correctness of each of them. 3. No person in the employment of ehB Residential has any authority to make or give any representations or warranty whatever in relation to this property on behalf of ehB Residential, nor enter into any contract on behalf of the Vendor. 4. No responsibility can be accepted for any expenses incurred by intending purchasers in inspecting properties which have been sold, let or withdrawn. Measurement and other information. All measurements are approximate. While we endeavour to make our sales particulars accurate and reliable, if there is any point which is of particular importance to you, please contact this office and we will be pleased to check the information for you, particularly if contemplating travelling some distance to view the properties. 5. The agents will require identity documentation and evidence of address before entering into any transaction under money laundering regulations 2007.